



PhxMesa **Gateway** Airport

# AIRPORT PROPERTY LEASING MAP

## North General Aviation Area

January 2009

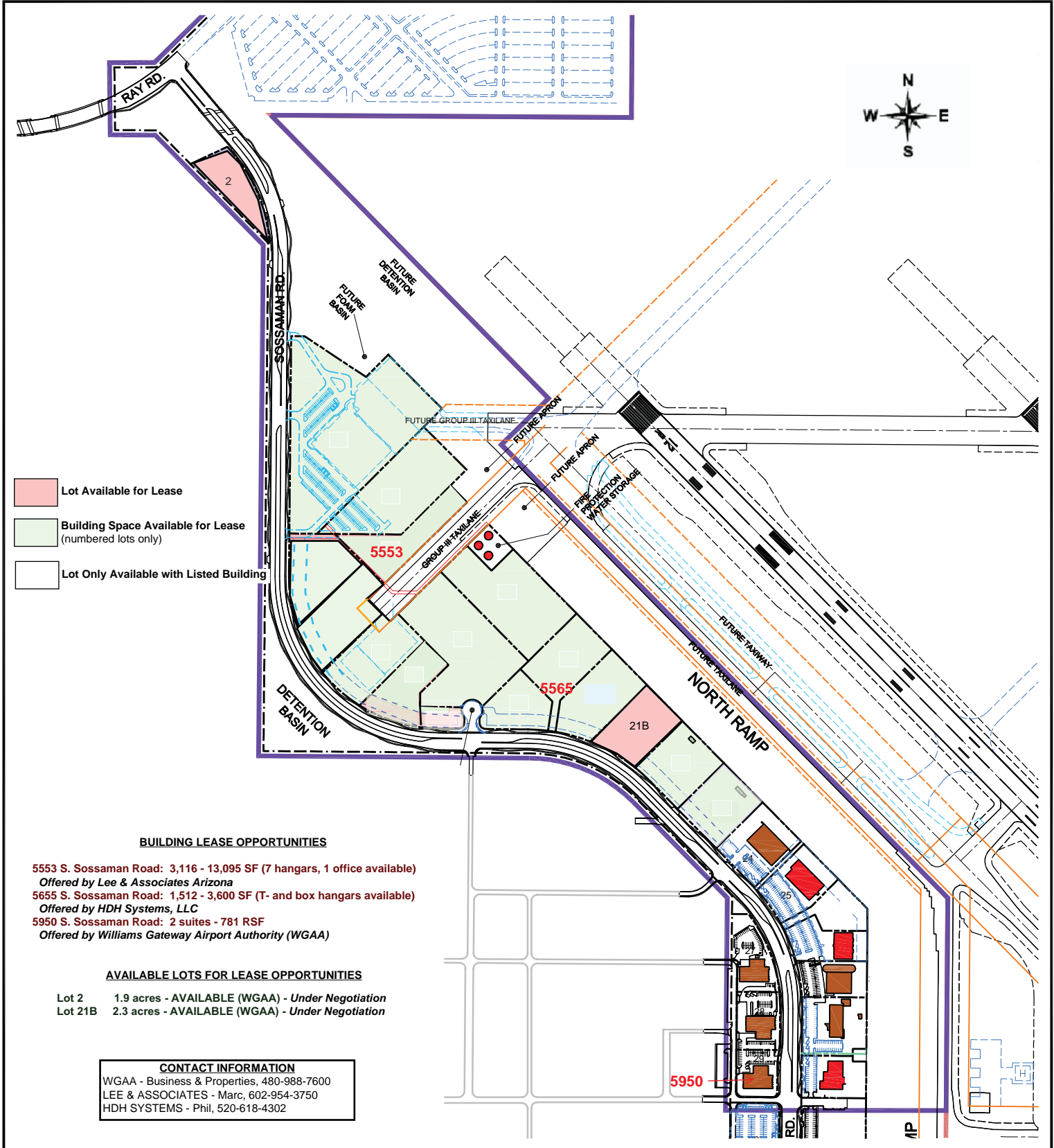

- Lot Available for Lease
- Building Space Available for Lease (numbered lots only)
- Lot Only Available with Listed Building

### BUILDING LEASE OPPORTUNITIES

- 5553 S. Sossaman Road: 3,116 - 13,095 SF (7 hangars, 1 office available)  
*Offered by Lee & Associates Arizona*
- 5655 S. Sossaman Road: 1,512 - 3,600 SF (T- and box hangars available)  
*Offered by HDH Systems, LLC*
- 5950 S. Sossaman Road: 2 suites - 781 RSF  
*Offered by Williams Gateway Airport Authority (WGAA)*

### AVAILABLE LOTS FOR LEASE OPPORTUNITIES

- Lot 2      1.9 acres - AVAILABLE (WGAA) - *Under Negotiation*
- Lot 21B   2.3 acres - AVAILABLE (WGAA) - *Under Negotiation*

**CONTACT INFORMATION**  
 WGAA - Business & Properties, 480-988-7600  
 LEE & ASSOCIATES - Marc, 602-954-3750  
 HDH SYSTEMS - Phil, 520-618-4302



PhxMesa Gateway Airport

# AIRPORT PROPERTY LEASING MAP

## South-Central Industrial Area

January 2009

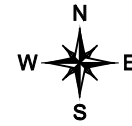

Commercial Airline Passenger Terminal

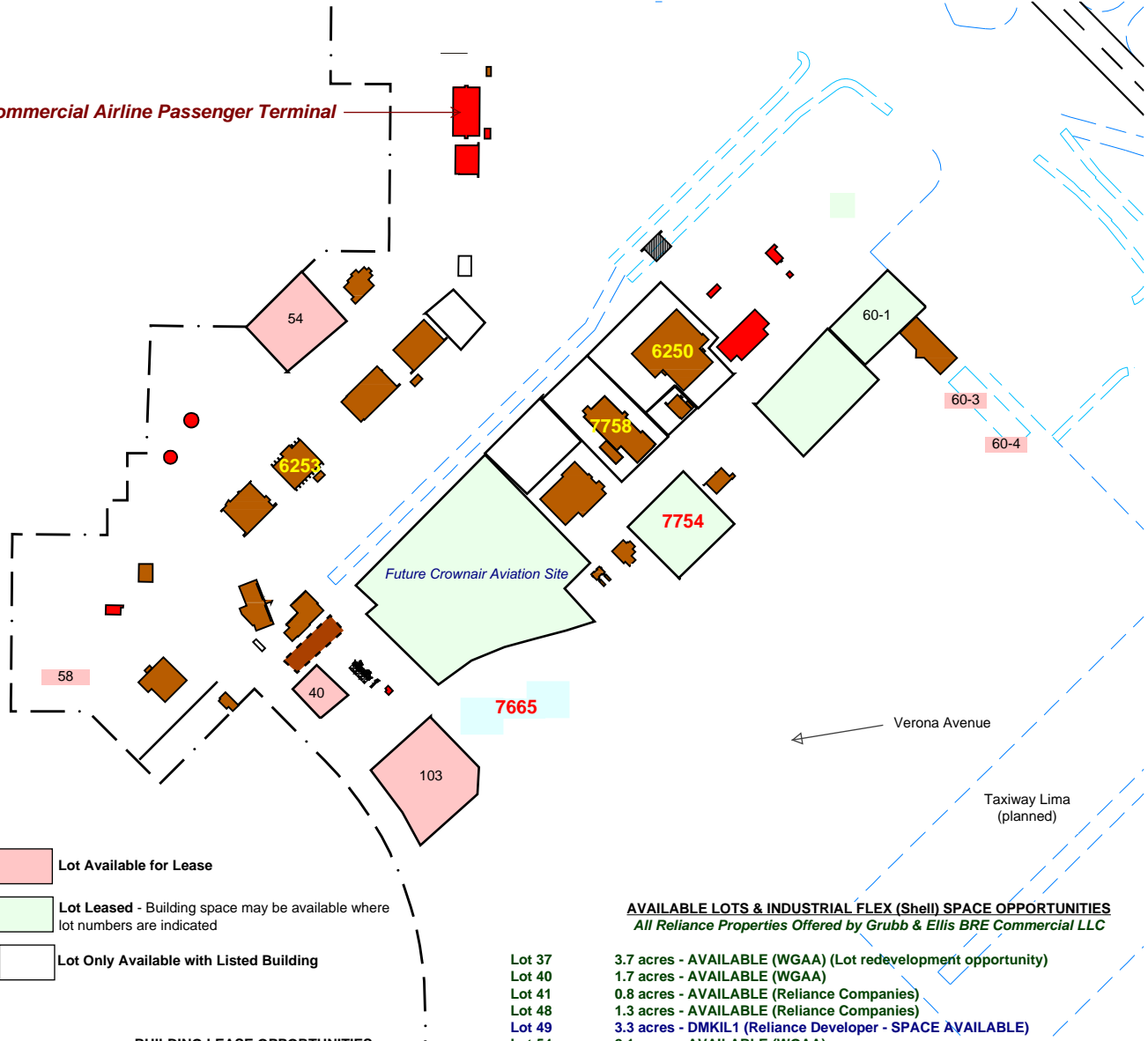

- Lot Available for Lease
- Lot Leased - Building space may be available where lot numbers are indicated
- Lot Only Available with Listed Building

### BUILDING LEASE OPPORTUNITIES

- 6253 S. Sossaman Road - 22,254 SF Covered Aircraft Storage Shell**  
Offered by Williams Gateway Airport Authority (WGAA)
- 6250 E. Taxiway Circle - 63,598 SF Hangar + Office + Shop Space**  
Offered by WGAA
- 7754 E. Velocity Way - 43,522 SF Office + Warehouse**  
Offered by Grubb & Ellis BRE Commercial LLC
- 7665 E. Velocity Way - 47,619 SF Office + Warehouse**  
Offered by Grubb & Ellis BRE Commercial LLC
- 7758 E. Taxiway Circle - 40,025 SF Office + Warehouse**  
Offered by WGAA

### CONTACT INFORMATION

WGAA - Business & Properties, 480-988-7600  
 RELIANCE COMPANIES - Grubb & Ellis BRE, 602-224-4404  
 HIMOVITZ PROPERTIES - Nikki, 480-403-1899

### AVAILABLE LOTS & INDUSTRIAL FLEX (Shell) SPACE OPPORTUNITIES

All Reliance Properties Offered by Grubb & Ellis BRE Commercial LLC

- Lot 37 3.7 acres - AVAILABLE (WGAA) (Lot redevelopment opportunity)
- Lot 40 1.7 acres - AVAILABLE (WGAA)
- Lot 41 0.8 acres - AVAILABLE (Reliance Companies)
- Lot 48 1.3 acres - AVAILABLE (Reliance Companies)
- Lot 49 3.3 acres - DMKIL1 (Reliance Developer - SPACE AVAILABLE)
- Lot 54 2.1 acres - AVAILABLE (WGAA)
- Lot 56B 1.7 acres - AVAILABLE (WGAA)
- Lot 58 3.0 acres - AVAILABLE (WGAA)
- Lot 60-1 1.9 acres - HIMOVITZ PROPERTIES (Developer - SPACE AVAILABLE)
- Lot 60-3 2.3 acres - AVAILABLE (WGAA)
- Lot 60-4 1.9 acres - AVAILABLE (WGAA)
- Lot 101 2.1 acres - AVAILABLE (Reliance Companies)
- Lot 102 2.1 acres - AVAILABLE (Reliance Companies)
- Lot 103 3.3 acres - AVAILABLE (Reliance Companies)
- Lot 106 2.1 acres - AVAILABLE (Reliance Companies)
- Lot 107 2.3 acres - AVAILABLE (Reliance Companies)
- Lots 108+109 4.4 acres - VELOCITY SQUARE LLC (Reliance Developer - SPACE AVAILABLE)
- Lot 110 2.2 acres - AVAILABLE (Reliance Companies)
- Lot 111 2.4 acres - AVAILABLE (Reliance Companies)
- Lot 112 2.6 acres - AVAILABLE (Reliance Companies)
- Lot 113 2.5 acres - AVAILABLE (Reliance Companies)
- Lot 114 2.5 acres - AVAILABLE (Reliance Companies)
- Lot 115 2.4 acres - AVAILABLE (Reliance Companies)
- Lot 116 2.2 acres - AVAILABLE (Reliance Companies)
- Lot 117 2.2 acres - AVAILABLE (Reliance Companies)
- Lot 118 2.2 acres - AVAILABLE (Reliance Companies)
- Lot 119 2.4 acres - AVAILABLE (Reliance Companies)
- Lot 120 2.2 acres - AVAILABLE (Reliance Companies)